



**MARTIN  
COMMERCIAL  
GROUP**  
Commercial Real Estate Services

# AVAILABLE FOR LEASE

14,270 SQ. FT. FREE STANDING INDUSTRIAL BUILDING WITH LARGE FENCED YARD



## 530 E. DYER ROAD ~ SANTA ANA

### Features:

- Approx. 1,744 Sq. Ft. HVAC Office Space
- Reception, Four (4) Private Offices & Break Room
- Four (4) 12'x14' GL Loading Doors
- 18' Warehouse Clearance
- Large Wrap-Around Fenced Yard
- Refurbished Throughout
- 800A 3P 120/208V (Verify)
- Close Proximity to 55, 5, 405, 22 & 73 Freeways
- Local Management & Leasing

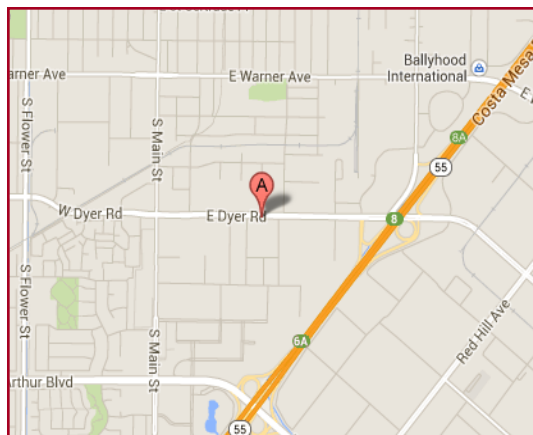

**For More Information  
Please Contact:**

### **SAM GREEK**

sgreek@mcgre.com  
DRE # 01240614

### **LORI MCAMIS**

lmcamis@mcgre.com  
DRE # 01873441

**714.241.1141**

1495 E. Warner Avenue  
Santa Ana, CA 92705

*Since 1953...  
Orange County ~ Inland Empire*

The information contained herein has been obtained from sources we deem reliable. While we have no reason to doubt its accuracy, we do not guarantee it.



MARTIN COMMERCIAL GROUP

Commercial Real Estate Services

For More Information Please Contact:

**SAM GREEK**

sgreek@mcgre.com  
DRE # 01240614

**LORI MCAMIS**

lmcamis@mcgre.com  
DRE # 01873441

**714.241.1141**

1495 E. Warner Avenue  
Santa Ana, CA 92705

*Since 1953...  
Orange County ~ Inland Empire*



## 530 E. Dyer Road, Santa Ana, CA 14,270 Sq. Ft.

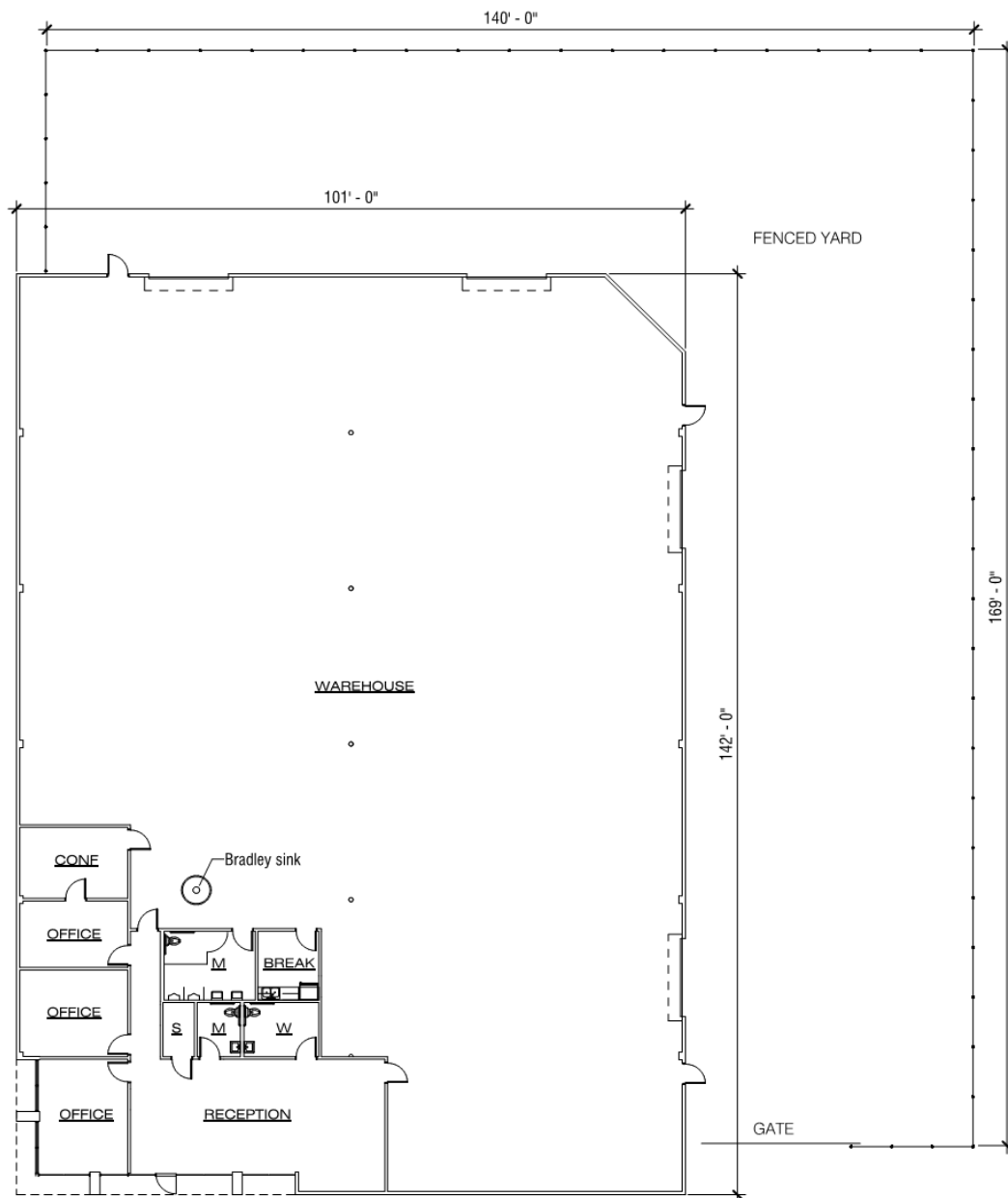

[WWW.MCGRE.COM](http://WWW.MCGRE.COM)